

NATURAL HEATING

PRODUCT INFORMATION

- Insert coat made of boiler steel, with thickness of 3 mm, P265GH grade in accordance with EN 10028-2
- Steel doors made of special profile, guaranteeing rigidity and high-temperature resistance.
- Heat-resistant ceramic glass with working temperatures of up to 800 ° C.
- Steel base of insert fitted with an intake throttle of outside cold air.
- Insert equipped with air curtain, to guarantee the maintenance of a substantially pure glass effect.
- Specially designed rear part of the body, designed for secondary air supply to the upper part of the furnace. Allows to increase the efficiency of the device by after-burning the exhaust fumes.

STANDARD VERTICAL FIREPLACE INSERT WITH A GUILLOTINE DOOR ALBERO AL9G.V

Nominal power (kW)	9
Heating load range (kW)	5-12
Flue diameter (mm)	180
Heat performance (%)	75
CO emission (with 13% O ₂)	0,092
Dust emission (g/m ³)	0,031
Exhaust emission (°C)	316
Weight (kg)	157
Log maximum length (cm)	30
Material	boiler steel with thickness of 3 mm P265GH
Fuel Type	hardwood, briquettes, lignite
Min. Active field of exhaust grilles (cm ²)	1000
Min. Active field of intake grilles (cm ²)	800
Size of fireplace glass (mm)	390 x 545

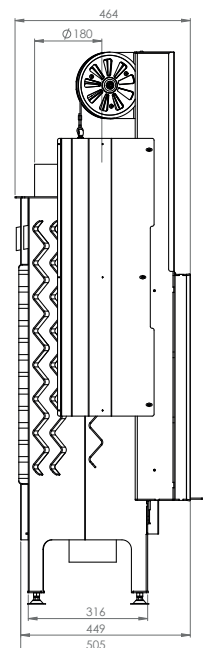
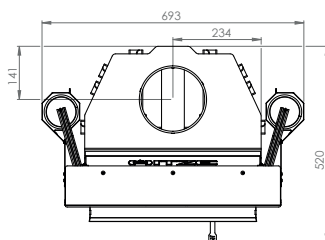
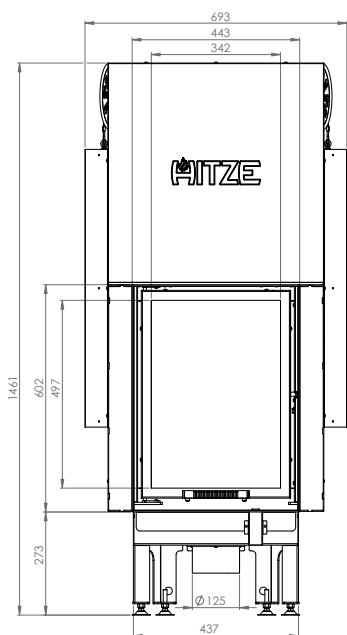

NATURAL HEATING

PRODUCT INFORMATION

- Insert coat made of boiler steel, with thickness of 3 mm, P265GH grade in accordance with EN 10028-2
- Steel doors made of special profile, guaranteeing rigidity and high-temperature resistance.
- Heat-resistant ceramic glass with working temperatures of up to 800 ° C.
- Steel base of insert fitted with an intake throttle of outside cold air.
- Insert equipped with air curtain, to guarantee the maintenance of a substantially pure glass effect.
- Specially designed rear part of the body, designed for secondary air supply to the upper part of the furnace. Allows to increase the efficiency of the device by after-burning the exhaust fumes.

LEFT-SIDED HORIZONTAL FIREPLACE INSERT ALBERO AL9L.H

Nominal power (kW)	9
Heating load range (kW)	5-10
Flue diameter (mm)	180
Heat performance (%)	84,9
CO emission (with 13% O ₂)	0,070
Dust emission (g/m ³)	0,038
Exhaust emission (°C)	194
Weight (kg)	107
Log maximum length (cm)	30
Material	boiler steel with thickness of 3 mm P265GH
Fuel Type	hardwood, briquettes, lignite
Min. Active field of exhaust grilles (cm ²)	900
Min. Active field of intake grilles (cm ²)	700
Size of fireplace glass (mm)	545 x 390 x 325

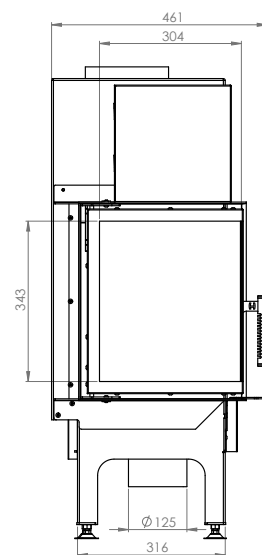
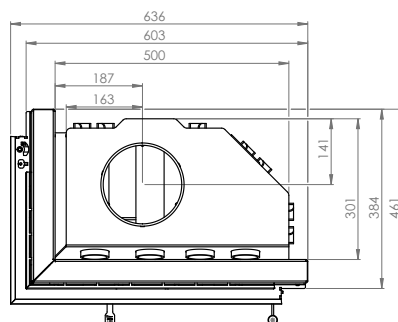
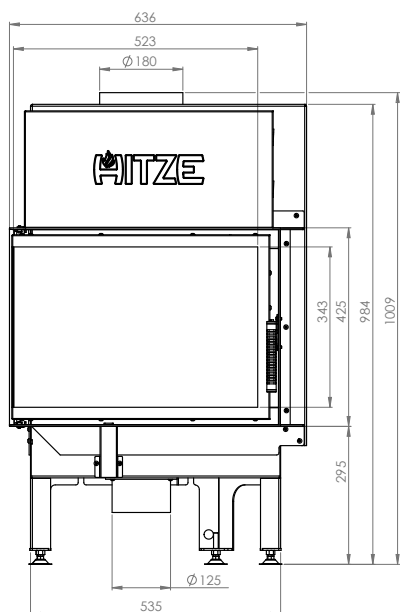

NATURAL HEATING

PRODUCT INFORMATION

- Insert coat made of boiler steel, with thickness of 3 mm, P265GH grade in accordance with EN 10028-2
- Steel doors made of special profile, guaranteeing rigidity and high-temperature resistance.
- Heat-resistant ceramic glass with working temperatures of up to 800 ° C.
- Steel base of insert fitted with an intake throttle of outside cold air.
- Insert equipped with air curtain, to guarantee the maintenance of a substantially pure glass effect.
- Specially designed rear part of the body, designed for secondary air supply to the upper part of the furnace. Allows to increase the efficiency of the device by after-burning the exhaust fumes.

LEFT-SIDED HORIZONTAL FIREPLACE INSERT WITH A GUILLOTINE DOOR **ALBERO AL9LG.H**

Nominal power (kW)	9
Heating load range (kW)	5-10
Flue diameter (mm)	180
Heat performance (%)	84.9
CO emission (with 13% O ²)	0,070
Dust emission (g/m ³)	0,038
Exhaust emission (°C)	194
Weight (kg)	153
Log maximum length (cm)	30
Material	boiler steel with thickness of 3 mm P265GH
Fuel Type	hardwood, briquettes, lignite
Min. Active field of exhaust grilles (cm ²)	900
Min. Active field of intake grilles (cm ²)	700
Size of fireplace glass (mm)	545 x 390 x 325

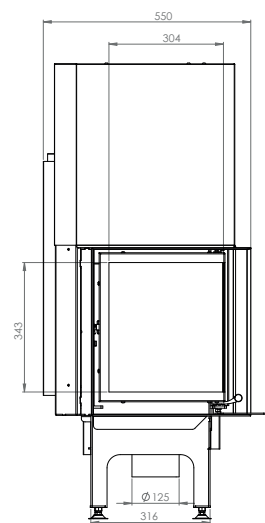
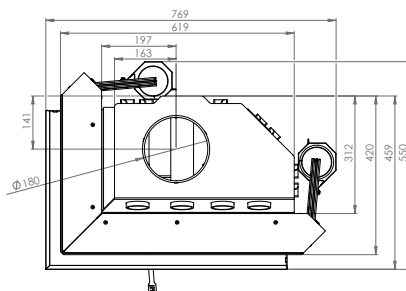
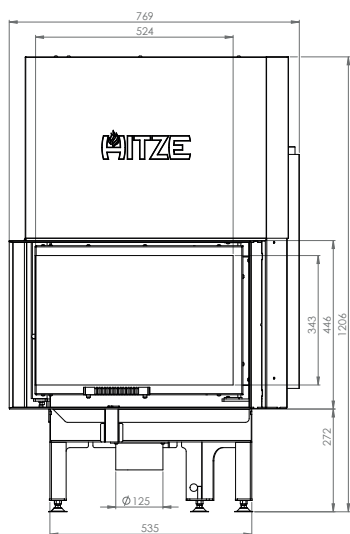

NATURAL HEATING

PRODUCT INFORMATION

- Insert coat made of boiler steel, with thickness of 3 mm, P265GH grade in accordance with EN 10028-2
- Steel doors made of special profile, guaranteeing rigidity and high-temperature resistance.
- Heat-resistant ceramic glass with working temperatures of up to 800 ° C.
- Steel base of insert fitted with an intake throttle of outside cold air.
- Insert equipped with air curtain, to guarantee the maintenance of a substantially pure glass effect.
- Specially designed rear part of the body, designed for secondary air supply to the upper part of the furnace. Allows to increase the efficiency of the device by after-burning the exhaust fumes.

RIGHT-SIDED HORIZONTAL FIREPLACE INSERT **ALBERO AL9R.H**

Nominal power (kW)	9
Heating load range (kW)	5-10
Flue diameter (mm)	180
Heat performance (%)	84,9
CO emission (with 13% O ²)	0,070
Dust emission (g/m ³)	0,038
Exhaust emission (°C)	194
Weight (kg)	107
Log maximum length (cm)	30
Material	boiler steel with thickness of 3 mm P265GH
Fuel Type	hardwood, briquettes, lignite
Min. Active field of exhaust grilles (cm ²)	900
Min. Active field of intake grilles (cm ²)	700
Size of fireplace glass (mm)	545 x 390 x 325

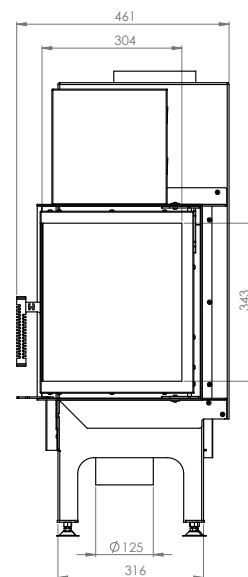
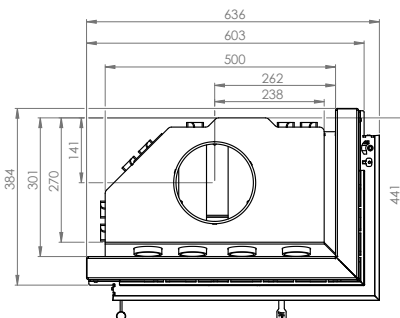
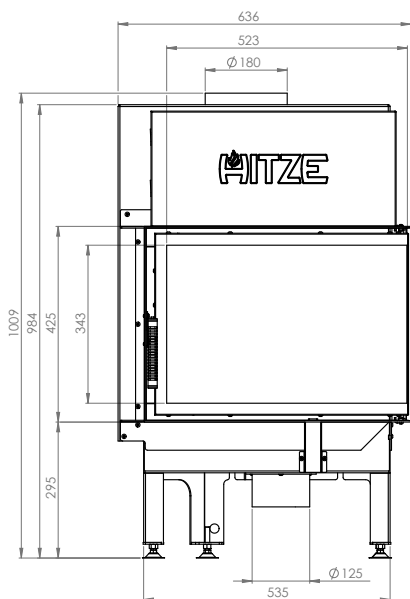

NATURAL HEATING

PRODUCT INFORMATION

- Insert coat made of boiler steel, with thickness of 3 mm, P265GH grade in accordance with EN 10028-2
- Steel doors made of special profile, guaranteeing rigidity and high-temperature resistance.
- Heat-resistant ceramic glass with working temperatures of up to 800 ° C.
- Steel base of insert fitted with an intake throttle of outside cold air.
- Insert equipped with air curtain, to guarantee the maintenance of a substantially pure glass effect.
- Specially designed rear part of the body, designed for secondary air supply to the upper part of the furnace. Allows to increase the efficiency of the device by after-burning the exhaust fumes.

RIGHT-SIDED HORIZONTAL FIREPLACE INSERT WITH A GUILLOTINE DOOR **ALBERO AL9RG.H**

Nominal power (kW)	9
Heating load range (kW)	5-10
Flue diameter (mm)	180
Heat performance (%)	84.9
CO emission (with 13% O ₂)	0,070
Dust emission (g/m ³)	0,038
Exhaust emission (°C)	194
Weight (kg)	159
Log maximum length (cm)	30
Material	boiler steel with thickness of 3 mm P265GH
Fuel Type	hardwood, briquettes, lignite
Min. Active field of exhaust grilles (cm ²)	900
Min. Active field of intake grilles (cm ²)	700
Size of fireplace glass (mm)	545 x 390 x 325

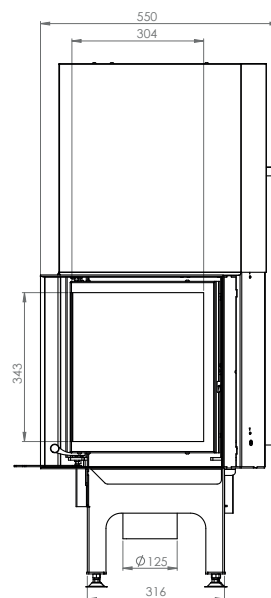
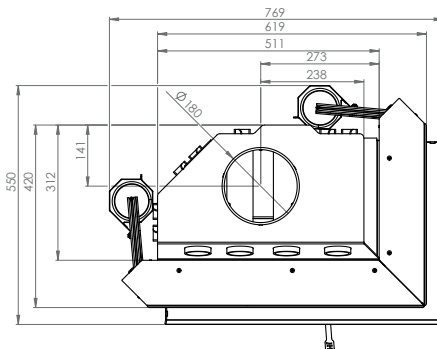
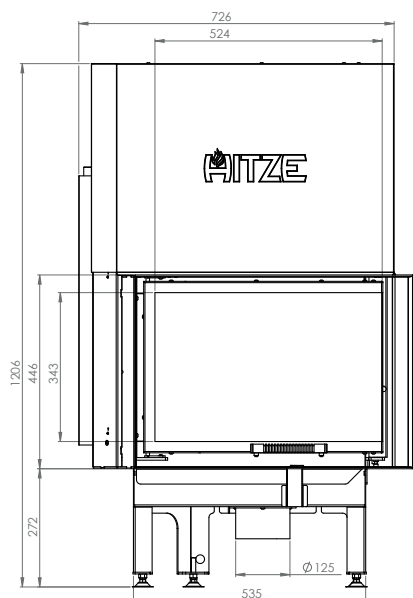

NATURAL HEATING

PRODUCT INFORMATION

- Insert coat made of boiler steel, with thickness of 3 mm, P265GH grade in accordance with EN 10028-2
- Steel doors made of special profile, guaranteeing rigidity and high-temperature resistance.
- Heat-resistant ceramic glass with working temperatures of up to 800 °C.
- Steel base of insert fitted with an intake throttle of outside cold air.
- Insert equipped with air curtain, to guarantee the maintenance of a substantially pure glass effect.
- Specially designed rear part of the body, designed for secondary air supply to the upper part of the furnace. Allows to increase the efficiency of the device by after-burning the exhaust fumes.

STANDARD HORIZONTAL FIREPLACE INSERT **ALBERO AL9S.H**

Nominal power (kW)	9
Heating load range (kW)	5-10
Flue diameter (mm)	180
Heat performance (%)	84,9
CO emission (with 13% O ₂)	0,070
Dust emission (g/m ³)	0,038
Exhaust emission (°C)	194
Weight (kg)	106
Log maximum length (cm)	30
Material	boiler steel with thickness of 3 mm P265GH
Fuel Type	hardwood, briquettes, lignite
Min. Active field of exhaust grilles (cm ²)	900
Min. Active field of intake grilles (cm ²)	700
Size of fireplace glass (mm)	545 x 390

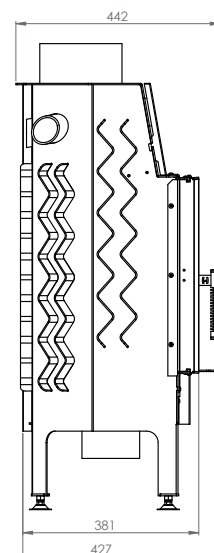
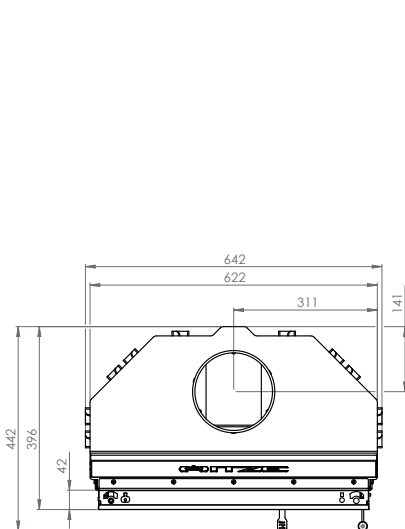
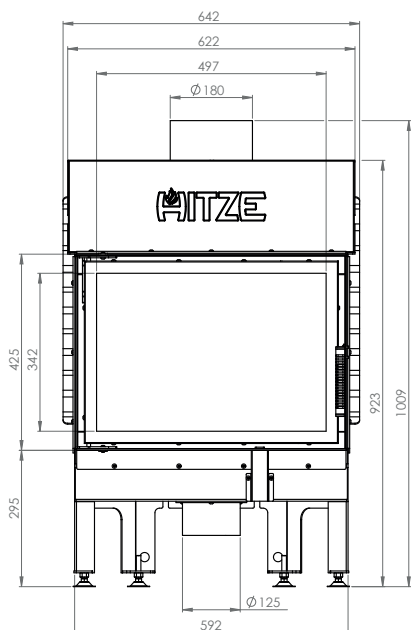

NATURAL HEATING

PRODUCT INFORMATION

- Insert coat made of boiler steel, with thickness of 3 mm, P265GH grade in accordance with EN 10028-2
- Steel doors made of special profile, guaranteeing rigidity and high-temperature resistance.
- Heat-resistant ceramic glass with working temperatures of up to 800 ° C.
- Steel base of insert fitted with an intake throttle of outside cold air.
- Insert equipped with air curtain, to guarantee the maintenance of a substantially pure glass effect.
- Specially designed rear part of the body, designed for secondary air supply to the upper part of the furnace. Allows to increase the efficiency of the device by after-burning the exhaust fumes.

STANDARD VERTICAL FIREPLACE INSERT ALBERO AL9S.V

Nominal power (kW)	9
Heating load range (kW)	5-12
Flue diameter (mm)	180
Heat performance (%)	75
CO emission (with 13% O ₂)	0,092
Dust emission (g/m ³)	0,031
Exhaust emission (°C)	316
Weight (kg)	104
Log maximum length (cm)	30
Material	boiler steel with thickness of 3 mm P265GH
Fuel Type	hardwood, briquettes, lignite
Min. Active field of exhaust grilles (cm ²)	1000
Min. Active field of intake grilles (cm ²)	800
Size of fireplace glass (mm)	390 x 545

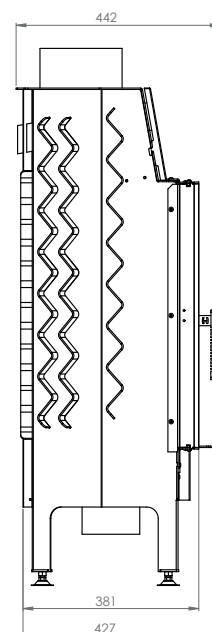
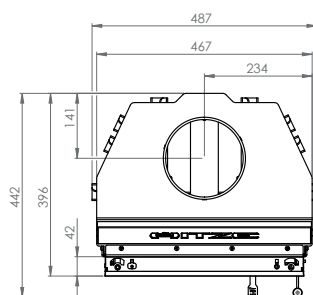
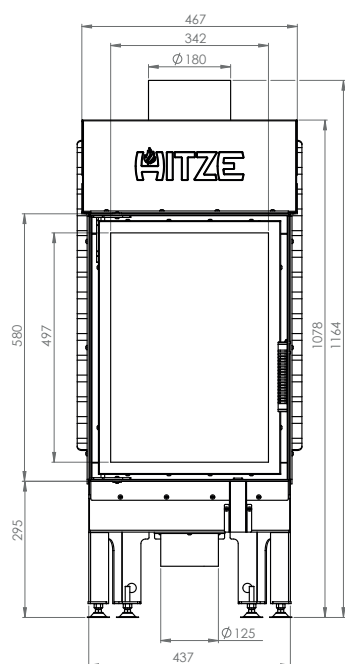

NATURAL HEATING

PRODUCT INFORMATION

- Insert coat made of boiler steel, with thickness of 3 mm, P265GH grade in accordance with EN 10028-2
- Steel doors made of special profile, guaranteeing rigidity and high-temperature resistance.
- Heat-resistant ceramic glass with working temperatures of up to 800 ° C.
- Steel base of insert fitted with an intake throttle of outside cold air.
- Insert equipped with air curtain, to guarantee the maintenance of a substantially pure glass effect.
- Specially designed rear part of the body, designed for secondary air supply to the upper part of the furnace. Allows to increase the efficiency of the device by after-burning the exhaust fumes.

HORIZONTAL FIREPLACE INSERT WITH A GUILLOTINE DOOR **ALBERO AL9G.H**

Nominal power (kW)	9
Heating load range (kW)	5-10
Flue diameter (mm)	180
Heat performance (%)	84.9
CO emission (with 13% O ²)	0,070
Dust emission (g/m ³)	0,038
Exhaust emission (°C)	194
Weight (kg)	107
Log maximum length (cm)	30
Material	boiler steel with thickness of 3 mm P265GH
Fuel Type	hardwood, briquettes, lignite
Min. Active field of exhaust grilles (cm ²)	900
Min. Active field of intake grilles (cm ²)	700
Size of fireplace glass (mm)	545 x 390

